

P:\180130.01 Zeeland - Washington Reconstruction\CADD\DWG\180130_COVER_SHEET.dwg, \$2,2019 4:54:17 PM, CONNOR KILPATRICK

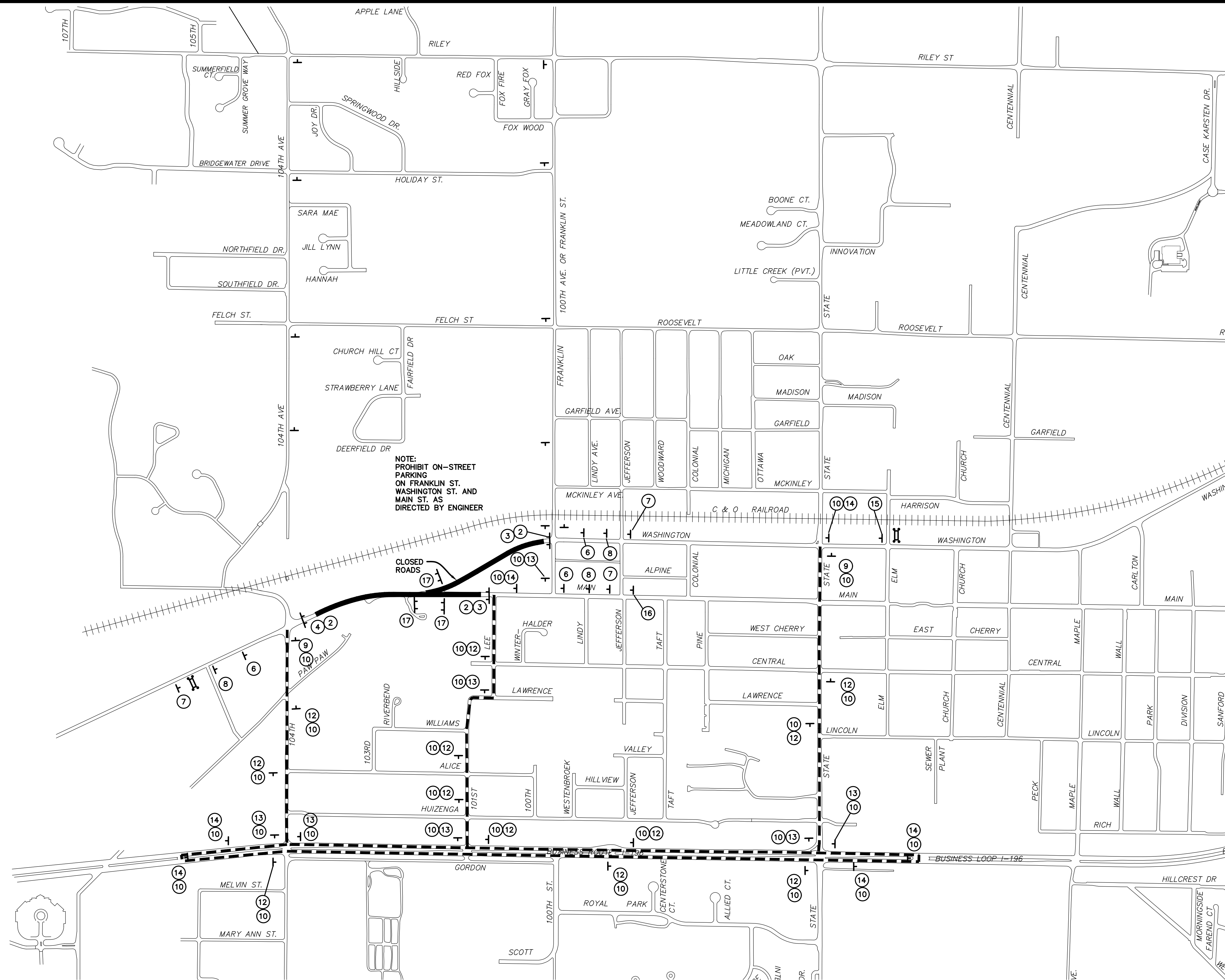

ESTIMATE OF TEMPORARY SIGN QUANTITIES

SIGN	MESSAGE	QTY.	IN. x IN.	SQ. FT.
SIGN, TYPE B TEMPORARY				
W20-3	ROAD CLOSED AHEAD	3	48 x 48	48
W20-2	DETOUR AHEAD	3	48 x 48	48
R5-18C	WORK ZONE BEGINS	0	48 x 48	0
R11-4	ROAD CLOSED TO THRU TRAFFIC	3	60 x 30	37.5
M4-10R	DETOUR & ARROW SYM. →	1	60 x 30	12.5
M4-10L	DETOUR & ARROW SYM. ←	2	60 x 30	25
M4-9	DETOUR & ARROW SYM. ↑	12	30 x 24	60
M4-9L	DETOUR & ARROW SYM. ←	6	30 x 24	30
M4-9R	DETOUR & ARROW SYM. →	7	30 x 24	35
M4-8A	DETOUR ENDS	3	24 x 18	9
W20-1	ROAD WORK AHEAD	3	48 x 48	48
R11-2	ROAD CLOSED	3	48 x 30	30
TOTAL, SIGN TYPE B TEMP				383

SF-1	WASHINGTON AVE.	27	30 x 18	101.25
SF-2	MAIN AVE.	0	30 x 18	0
SF-3	WASHINGTON CLOSED AT FRANKLIN	1	60 x 30	12.5
SF-4	MAIN CLOSED AT LEE	1	60 x 30	12.5
TOTAL, SIGN TYPE B TEMP, SPECIAL				171.25

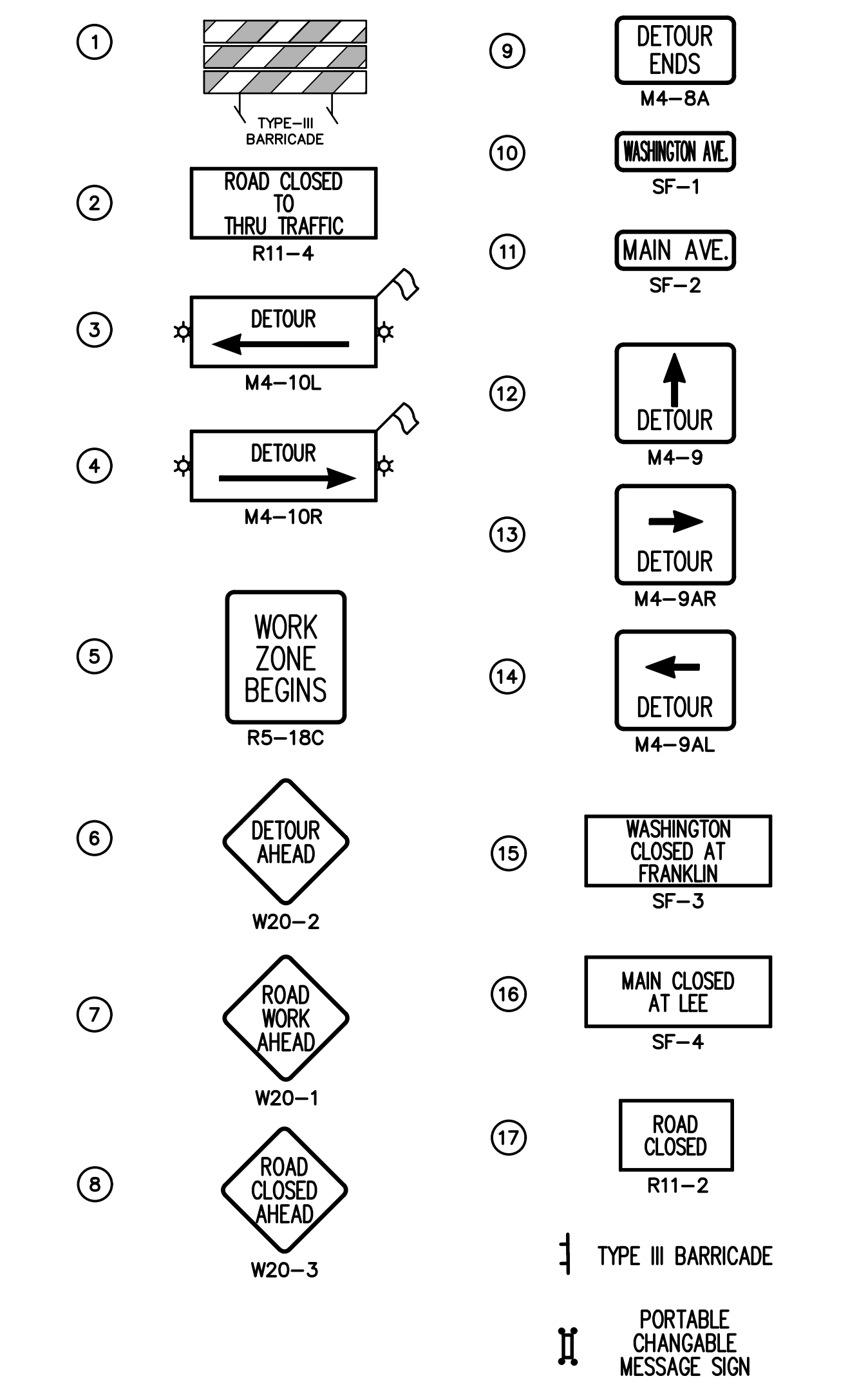

PLAN REVISIONS	
02-01-19	REV. PER G.I. COMMENTS
02-01-19	REV. PER CITY OF ZEELAND
05-02-19	DETOUR PLAN

Moore+Bruggink
 Consulting Engineers
 2020 Monroe Ave.
 Grand Rapids, MI 49505
 (616) 363-9801 mail@moorebruggink.com

DESIGN DRAWN BY:	CFB
DESIGNED BY:	PL
CHECKED BY:	AP
PLAN DATE:	JULY 30, 2018

MAINTAINING TRAFFIC
 IN
WEST WASHINGTON AVENUE
 FROM 670 FT EAST OF 670 FT EAST OF 104TH AVE. TO N. FRANKLIN ST.
 CITY OF ZEELAND, OTTAWA COUNTY, MICHIGAN

FIELD SURVEY / DATE	M&B
PROJECT NO.	180130.01
SHEET NUMBER	32 OF 43